

PRODUCT SHEET  
REV 2.1 - EN202003  
**FS346 SWING  
DANCER 2**

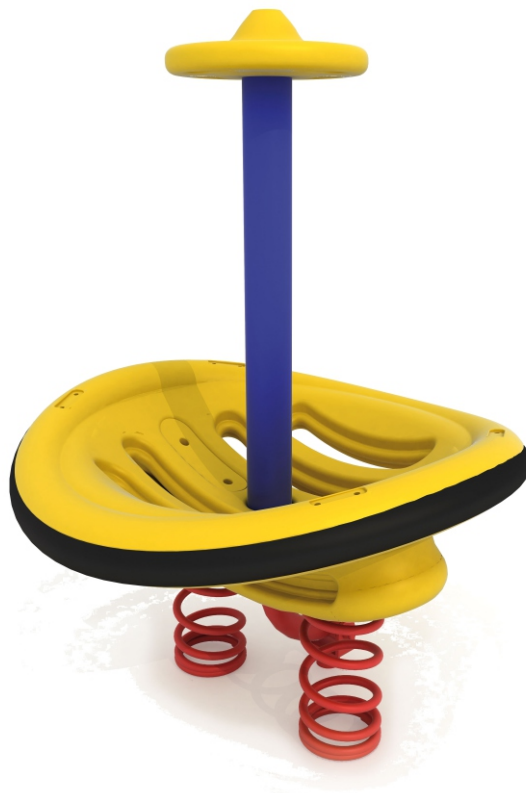

ORGANIZATION WITH QUALITY MANAGEMENT SYSTEM  
ISO 9001:2015 CERTIFIED by  
EuCI European Certification Institute LTD  
Certificate N.: GOTT253201932

ORGANIZATION WITH ENVIRONMENTAL MANAGEMENT SYSTEM  
ISO 14001:2015 CERTIFIED by  
EuCI European Certification Institute LTD  
Certificate No: GOTT2532E1801



ROCKING

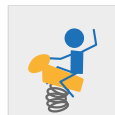

<b>CATALOG COLLECTION</b>	PLAYGROUND ESSENTIALS
<b>DIMENSIONS (L x W x H) in cm</b>	Ø112 x 155
<b>MAXIMUM CFH</b>	120
<b>IMPACT ATTENUATING SURFACE</b>	min. 16,00 m <sup>2</sup> - MAX 16,00 m <sup>2</sup>
<b>SUGGESTED AGE OF USE</b>	3+
<b>COMPOSITION</b>	Rotating mold PE structure with EPDM rubber bumper and powder coated metal handles. Oscillating on two steel springs with powder coated metal articulated support pillar.

SECURITY AREA

← 412 →

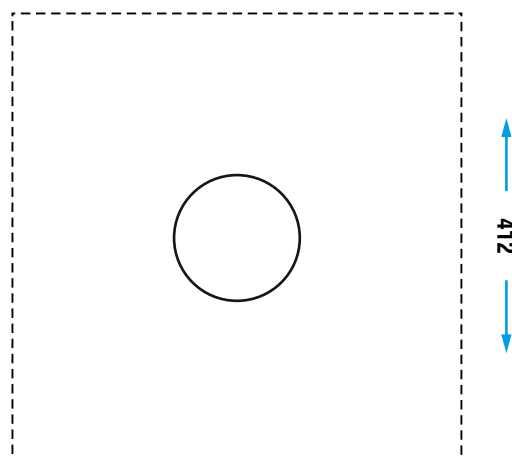

Make a proper security surface according to CFH. Periodic maintenance is mandatory, following manual supplied to customer.